



SENTRY MICROMAG MAGNETIC FILTER

Sentry SmartSkin

MAGNETIC SEPARATORS

Ensure your wash station's functionality and efficiency with Sentry SmartSkin MicroMag Magnetic Filters.

MicroMag's compact yet powerful construction ensures your equipment remains efficient by removing free-floating contaminants. The magnetic filter's process allows fluid to enter through an inlet port and be dispersed to a magnetic core where particles are contained. The magnetic flux circuit's geometry means contamination builds up in a controlled way, ensuring that the filter can never block, irrespective of how much contamination is held.

Sentry's magnetic separator reduces the need for maintenance by maintaining continuous flow and controlling core build-up. This patented design comes in various sizes and PSI limits to meet your unique needs.

FEATURES

- Sub-micron filtration
- Large holding capacity
- Suitable for all metalworking applications
- Utilizes no consumables



MM



MM/HP/80



Sample. Monitor. Measure.

SENTRY

Any Application. Anywhere.

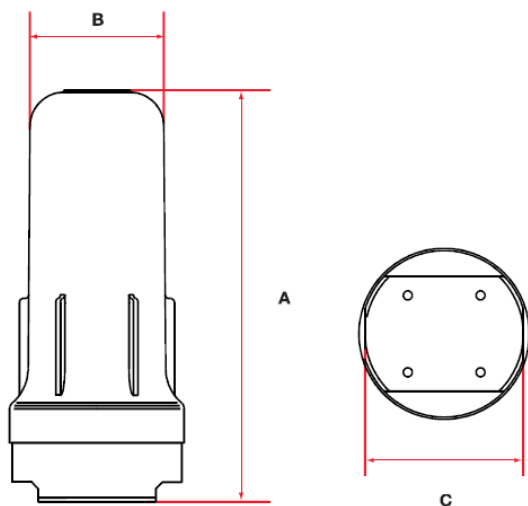

Product number	Flow rate Gallons	Contamination capacity lbs	Max. operating pressure psi	Connection NPT "	Temperature range F	Construction	Dimensions inches		
							A	B	C
MM5 /1.0	18	2.2	174	1	41-122	SAN housing, aluminum lid	7.5	3.7	4.1
MM10 /1.0	26	4.4	174	1	41-122		12.4	4.0	4.9
MM20 /1.5	40	8.8	174	1½	41-122		23.9	4.0	5.3
MM5/HP/50 NPT	18	2.2	725	1	32 – 284	Full aluminum construction	9.7	4.6	4.9
MM10/HP/50 NPT	26	4.4	725	1	32 – 284		14.3	4.6	4.9
MM20/HP/50 NPT	40	8.8	725	1½	32 – 284		24.6	4.6	4.9
MM5/HP/80 NPT	18	2.2	1160	1	32 – 284	Full stainless steel construction	9.7	4.6	4.9
MM10/HP/80 NPT	26	4.4	1160	1	32 – 284		14.3	4.6	4.9
MM20/HP/80 NPT	40	8.8	1160	1½	32 – 284		24.6	4.6	4.9

SPECIFICATIONS

Input Power	1 in NPT
Materials of Construction	Stainless Steel (other materials available upon request)
Maximum Process Pressure	1160 PSI at 284°F (80 barg at 140°C)
Flow Rate	40 GPM

sentry-equip.com

966 Blue Ribbon Circle North, Oconomowoc, WI 53066 U.S.A. | +1-262-567-7256 | sales@sentry-equip.com

© 2015 Sentry Equipment Corp. All rights reserved. All product and company names are property of their respective owners. It is solely the responsibility of end users, through their own testing and analysis, to select products and materials suitable for their specific application requirements, ensure they are properly installed, safely applied and properly maintained, and to limit their use to their intended purpose. Improper selection, installation or use may result in personal injury or property damage.

S-SW-SPS-00434-0 5-15



COMPANY WITH
QUALITY SYSTEM
CERTIFIED BY DNV GL
= ISO 9001 =