



Gas



Liquid & Slurry



Solid & Powder



Steam & Water

SENTRY SC SAMPLE CUTTER

Automatic Sampling Accessories

AUTOMATIC SAMPLING

The Sentry® SC sample cutter is designed to reduce the size of a sample obtained by a primary sampler when the primary sampler provides an excess volume of sample.

The material enters a pendulum which swings back and forth over an adjustable stationary pelican. The material falls into the opening of the pelican and is diverted through a flexible hose to a collection point. The excess material is returned to the main process flow.

MODELS

SC

BENEFITS

With representative sampling, characteristics of each sample match that of the entire lot or batch—so samples are repeatable, leading to accurate sample analysis data. Automatic sampling ensures a sample can be easily and safely obtained with no need for direct human interface or interference. This ensures sample integrity as well as operator safety.

FEATURES

- Customized to meet various application needs
- Wetted components are 300 series stainless steel
- White nitrile seals or gaskets
- Designed to eliminate the degradation of sample material
- No moving parts in conveyance from sampler to container, keeping material characteristics consistent
- Dust and vapor resistant
- CE and ATEX compliant models available
- Adjustable pelican opening available
- Optional release coating to ensure a non-stick surface
- QPQ hardening of contact surfaces available to protect against wear and abrasion
- Explosion proof (XP) motor available



Sample. Monitor. Measure.

SENTRY

Any Application. Anywhere.

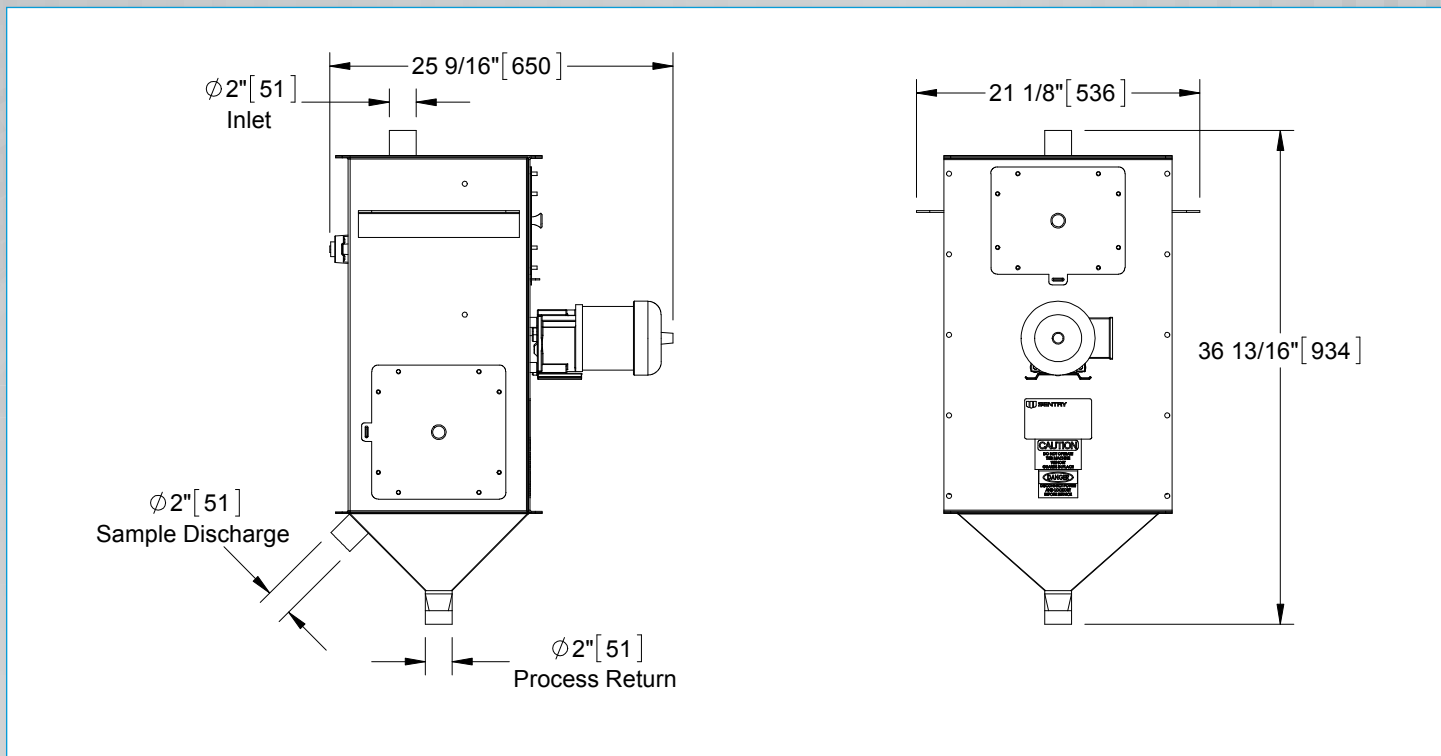

SPECIFICATIONS	
materials	300 series stainless steel, white nitrile
motor	1/6 HP gearmotor, 16 RPM, 115/230 V, 1 ph, 60 Hz; 110/220 V, 1 ph, 50 Hz TEFC
electrical requirements	115/230 V, 1 ph, 60 Hz or 110/220 V, 1 ph, 50 Hz
temperature rating	-20 to 180°F (-29 to 82°C)
suggested connection to sample discharge	rigid metal or flexible tubing to a collection container or indexing cabinet
inlet size	2, 3 or 4 in (51, 76 or 102 mm) diameter
recommended sampler location	gravity fed; place at an elevation below and as close as possible to the sampler
collection containers	PET jar, 304 stainless steel jar, bag
pressure rating	ATM
shipping weight	approx. 100 lb (45 kg)

sentry-equip.com

966 Blue Ribbon Circle North, Oconomowoc, WI 53066 U.S.A. | +1-262-567-7256 | sales@sentry-equip.com

© 2016 Sentry Equipment Corp. All rights reserved. All product and company names are property of their respective owners. It is solely the responsibility of end users, through their own testing and analysis, to select products and materials suitable for their specific application requirements, ensure they are properly installed, safely applied and properly maintained, and to limit their use to their intended purpose. Improper selection, installation or use may result in personal injury or property damage.

S-SP-SPS-00177-4 6-16



COMPANY WITH
QUALITY SYSTEM
CERTIFIED BY DNV GL
= ISO 9001 =