



MODEL D2 Automatic Sampler Tube and Auger Sampler for Non Free-Flowing Materials



Features

- Low height requirements
- Includes 316 stainless steel tube and auger
- Slotted tube rotates 180° introducing material to the auger which positively extracts the sample
- Close tolerance (0.003" / 0.008 cm) between the auger and tube assures self-cleaning
- Rotating slotted sample tube allows for sample clean out to prevent cross-contamination

Options

- Custom mounting adapters
- Custom tube and auger design
- Pre-mounted in lines, spouts or hoppers
- Nickel-impregnated Teflon® for a non-stick surface
- Hardening treatments to protect against wear and abrasion

Description

The Model D2 automatically takes a strip sample of either free-flowing or non free-flowing materials in gravity chutes and hoppers. Bulk solids such as pellets, powders, flakes and granules can be sampled.

The Model D2 collects a sample when a solenoid-operated actuator rotates a slotted sample tube through the product flow, taking a cross-sectional sample. Simultaneously a motor-driven auger draws the product to the discharge point.

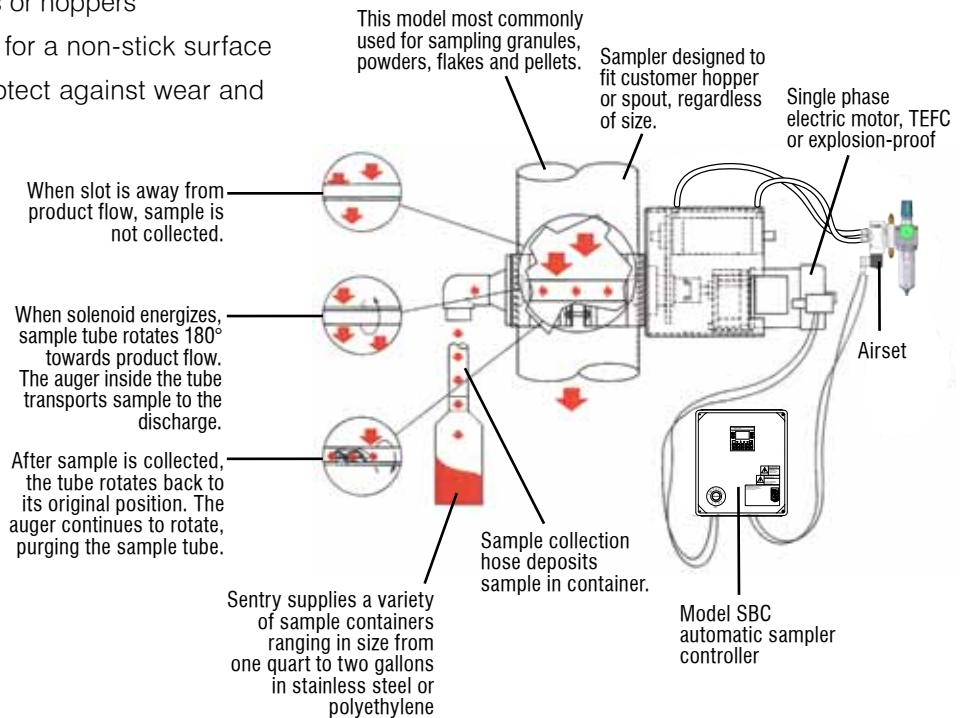

MODEL D2 TECHNICAL DATA

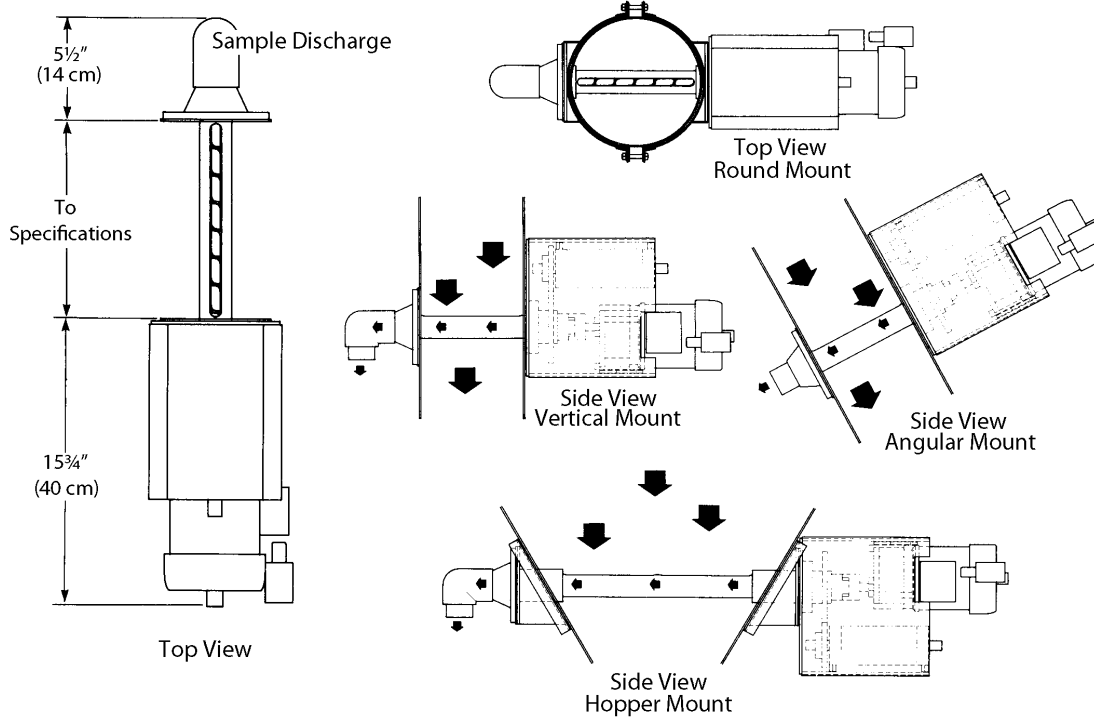

SPECIFICATIONS

Basic Electrical Requirements	120 VAC, single phase; control box fused to 2 amps (other voltages available)
Air Requirements	80 psig, 1.5 ft ³ /cycle (5.5 barg, 42.5 l/cycle)
Quantity of Sample	determined by flow rate and aperture size and time in line
Product Size	10 μm - 1/4" (6 mm); larger sizes upon request
Recommended Location of Sampler	vertical gravity line
Suggested Connection to Collection Point	rigid metal or flexible tubing to a container or indexing cabinet
Materials of Construction	316 stainless steel sampling tube and auger
Temperature Range	up to 250°F (121°C)

NOTE: Teflon is a registered trademark of E. I. Du Pont de Nemours and Company.

WARNING

It is solely the responsibility of the end-user, through its own analysis and testing, to select products and materials suitable for their specific application requirements, ensure they are properly installed, safely applied, properly maintained, and limit their use to their intended purpose. Improper selection, installation, or use may result in personal injury or property damage.



SENTRY EQUIPMENT CORP

966 Blue Ribbon Circle North
Oconomowoc, WI 53066 USA
Tel: 262-567-7256 • Fax: 262-567-4523

E-mail:
sales@sentry-equip.com

Website:
www.sentry-equip.com



For further information, contact: